

TENDA A RULLO LIBERA

senza guide né cassonetto
movimentazione
catena - argano - motore

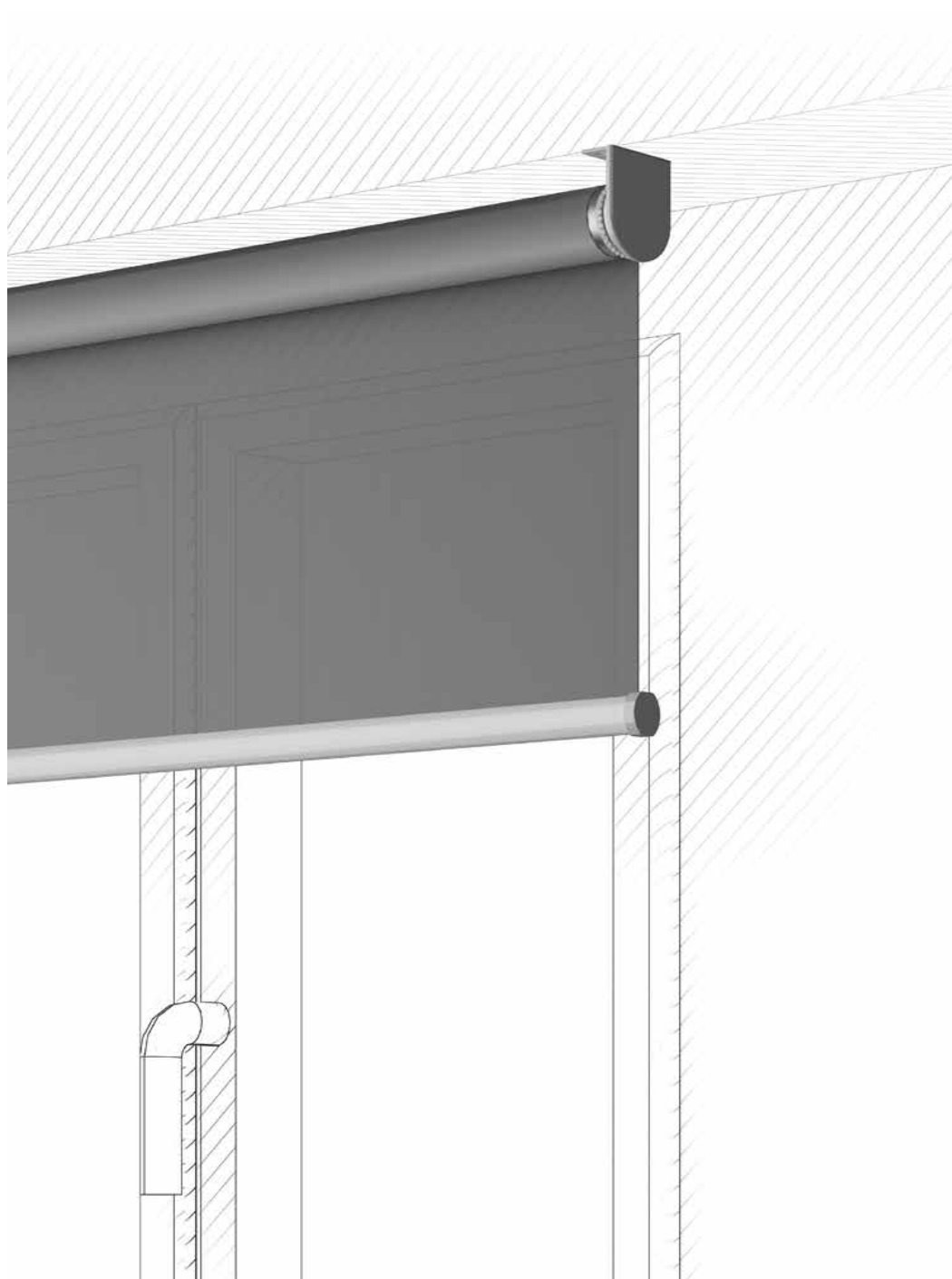

Componenti

AVVOLGITORE	MATERIALE	Tubo di alluminio estruso con ogiva
FONDALE	MATERIALE	Alluminio estruso verniciato a polveri
VITERIA	MATERIALE	Acciaio
MANOVRE	MOTORE	Corrente alternata AC a 230V / 14 - 16 rpm
	ARGANO	Con giunto snodato, asta e manovella snodabile
	CATENA	Frizionata in plastica oppure metallica
SUPPORTI	FINITURA	Acciaio con cuffie antiurto
TIPI DI INSTALLAZIONE		Frontale con supporto / A soffitto
DIMENSIONI	LARGHEZZA (mm)	600 min - 4400 max
	ALTEZZA	In funzione del telo
CONFEZIONE TELO	AVVOLGITORE	Cavetto con nastro
	FONDALE	Tasca con tondino

Ingombri tecnici

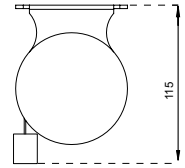
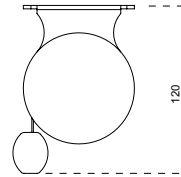
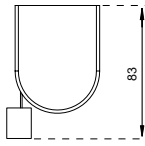
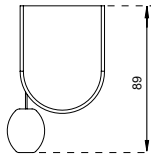

Supporto per tubo Ø43

Supporto per tubo Ø60/78

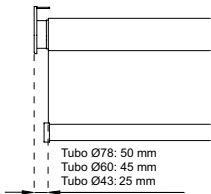

Tolleranza laterale del tessuto su tubo Ø43: 25mm

Modalità d'installazione

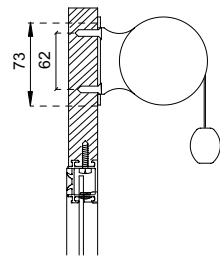
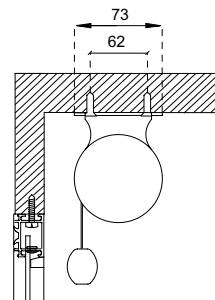
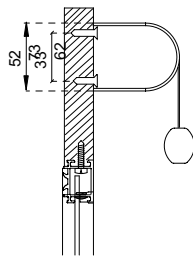
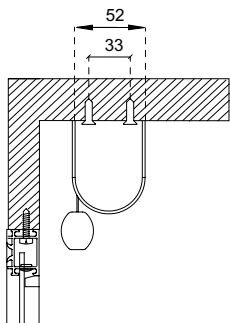

Montaggio a soffitto

Montaggio a muro

Montaggio a soffitto

Montaggio a muro

Configurazioni

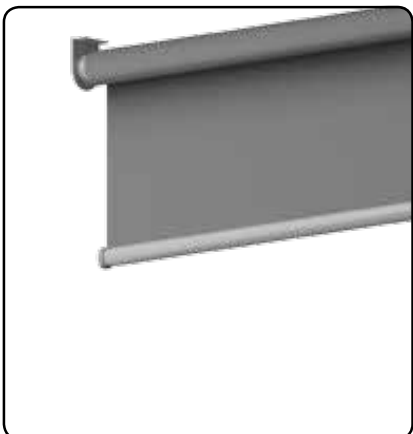

Supporto per tubo 43



Supporto per tubo Ø60/78

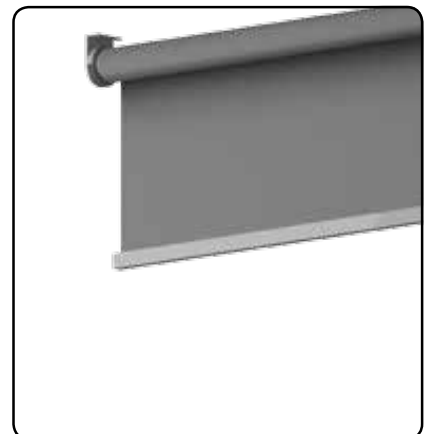

Fondale 15 x 20

Applicazioni particolari

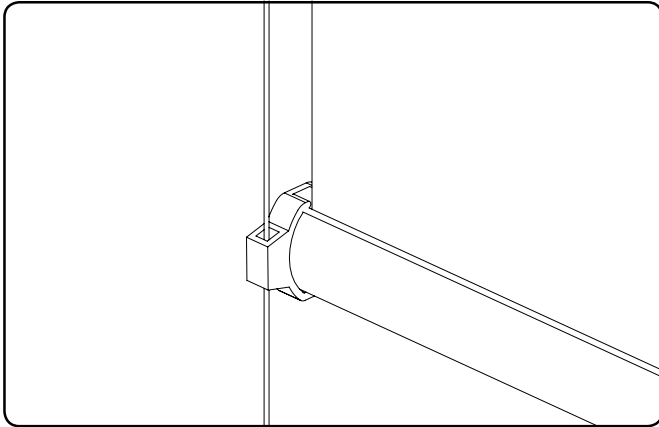

Guida perlite o acciaio

Fondali

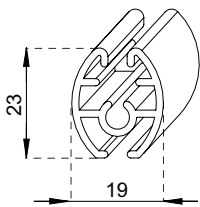

19x23

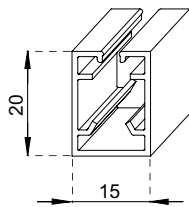

15x20



22x22

Guide

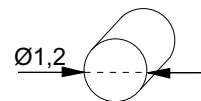

Avvolgitori

