

## TENDA A RULLO LIBERA

**senza guide né cassonetto**  
**movimentazione**  
**catena - argano - motore**

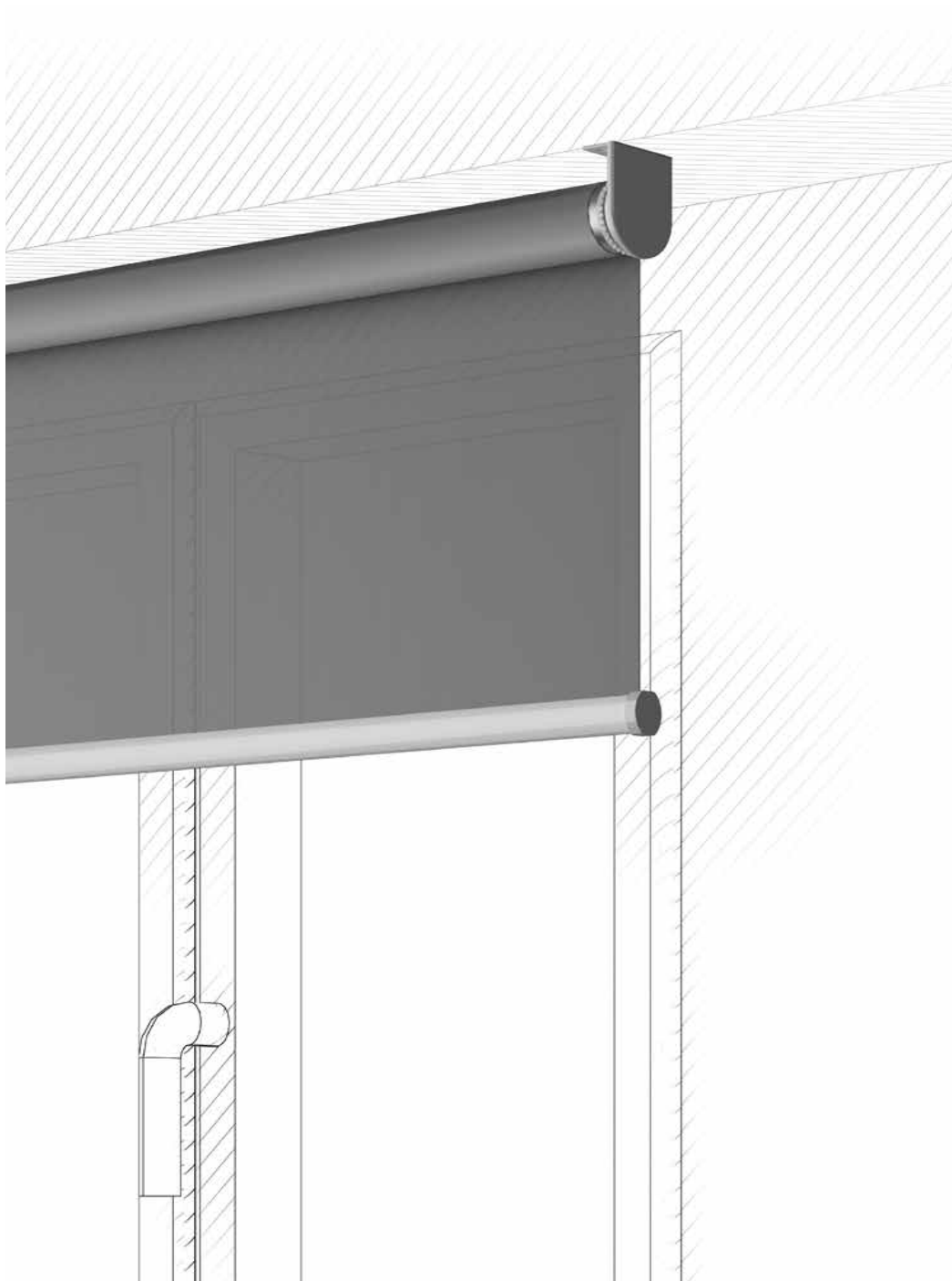

## Componenti

<b>AVVOLGITORE</b>	MATERIALE	Tubo di alluminio estruso con ogiva
<b>FONDALE</b>	MATERIALE	Alluminio estruso verniciato a polveri
<b>VITERIA</b>	MATERIALE	Acciaio
<b>MANOVRE</b>	MOTORE	Corrente alternata AC a 230V / 14 - 16 rpm
	ARGANO	Con giunto snodato, asta e manovella snodabile
	CATENA	Frizionata in plastica oppure metallica
<b>SUPPORTI</b>	FINITURA	Acciaio con cuffie antiurto
<b>TIPI DI INSTALLAZIONE</b>		Frontale con supporto / A soffitto
<b>DIMENSIONI</b>	LARGHEZZA (mm)	600 min - 4400 max
	ALTEZZA	In funzione del telo
<b>CONFEZIONE TELO</b>	AVVOLGITORE	Cavetto con nastro
	FONDALE	Tasca con tondino

## Ingombri tecnici

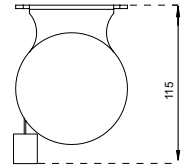
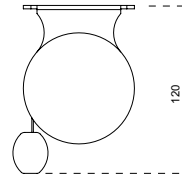
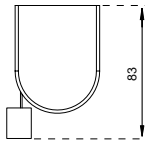
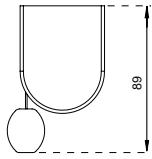

Supporto per tubo Ø43

Supporto per tubo Ø60/78

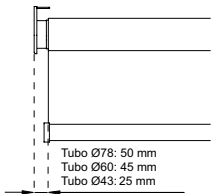

Tolleranza laterale del tessuto su tubo Ø43: 25mm

## Modalità d'installazione

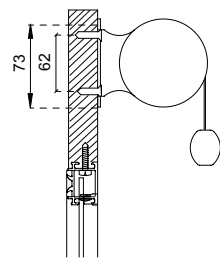
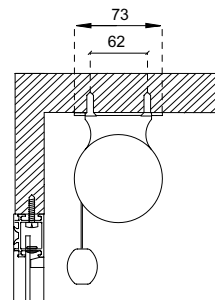
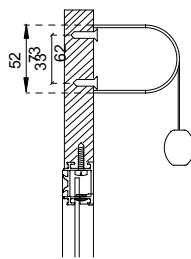
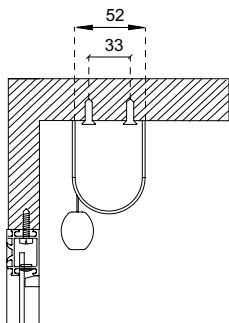

Montaggio a soffitto

Montaggio a muro

Montaggio a soffitto

Montaggio a muro

## Configurazioni

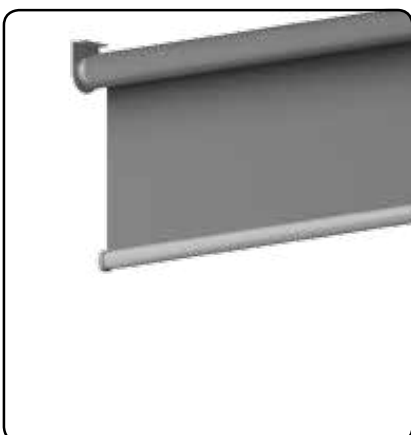

Supporto per tubo Ø43

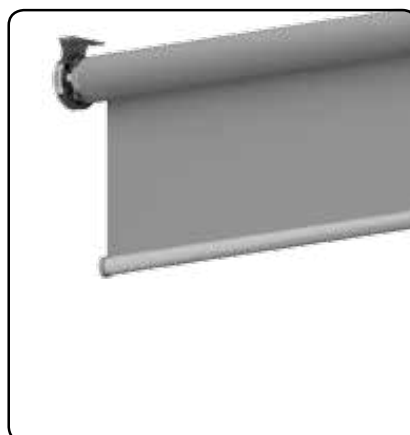

Supporto per tubo Ø60/78

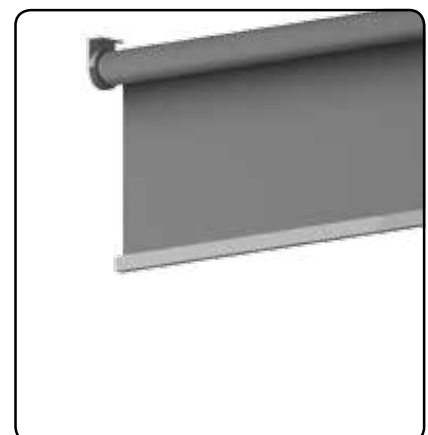

Fondale 15 x 20

## Applicazioni particolari

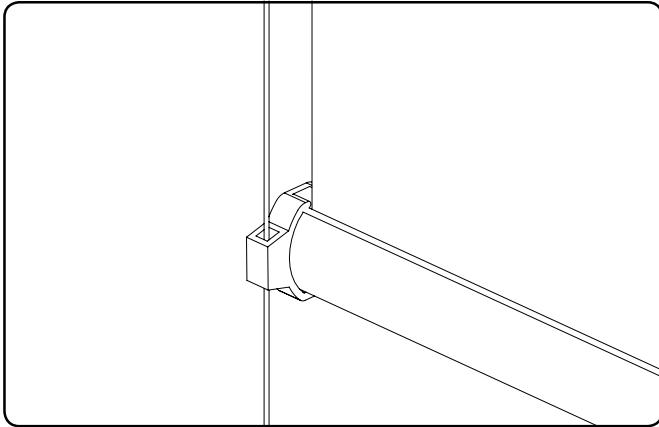

Guida perlon o acciaio

## Fondali

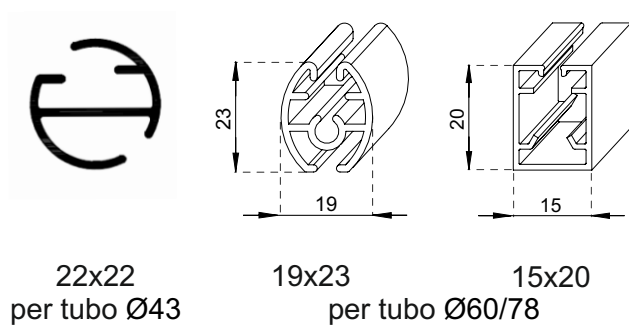

## Guide

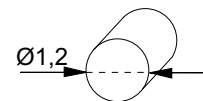

## Avvolgitori

